

**Product Code****SDS-TW-007-12**  
**SDS-TW-007-24****Nominal Dimensions**

1" X 12" and 1" X 24"

**Description**

The updated #7 Secure Mini Dukt™ (SMD) Through-Wall Kit provides a 1" through-wall pathway in multiple installation scenarios, including:

- SMD Tube to SDS 2"x2" Secure Raceway or Secure Large Carrier (SLC) Raceway
- SMD Tube with SMD Connector to SDS 2"x2" Raceway or SLC Raceway
- SMD Tube to a User Drop Box or other enclosure

The newer components provide maximum inside diameter, smoother cable movement, and powder-coated trim ring and coupler for a more finished appearance.

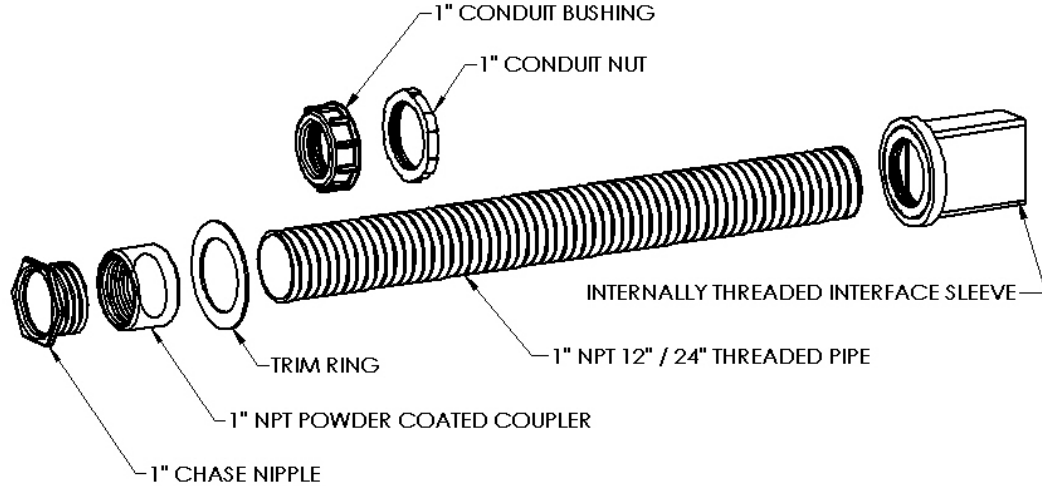
[Installation Instructions](#)
**Specifications**

12"	24"
<ul style="list-style-type: none"> <li>• Galvanized steel threaded pipe</li> <li>• Total weight: 2 lbs</li> </ul>	<ul style="list-style-type: none"> <li>• Galvanized steel threaded pipe</li> <li>• Total weight: 3 lbs</li> </ul>
<b>Through-Wall Kit includes:</b>	<b>Through-Wall Kit includes:</b>
• One (1) – 1"x12" NPT threaded pipe	• One (1) – 1"x24" NPT threaded pipe
• One (1) – 1" conduit bushing	• One (1) – 1" conduit bushing
• One (1) – 1" conduit lock nut	• One (1) – 1" conduit lock nut
• One (1) – 1" Chase nipple	• One (1) – 1" Chase nipple
• One (1) – 1" NPT powder-coated coupler	• One (1) – 1" NPT powder-coated coupler
• One (1) trim ring	• One (1) trim ring
• One SMD Interface Sleeve	• One SMD Interface Sleeve



Holocom, Inc.  
[www.holocom.com](http://www.holocom.com)

PRODUCT CODE:

**SDS-TW-007-12 / SDS-TW-007-24**

TITLE:

#7 THROUGH-WALL KIT

All material contained in this document is the property of Holocom, Inc. and may not be reproduced or transmitted (including electronically) without the written consent of Holocom, Inc. Holocom and the Holocom logo are registered trademarks of Holocom, Inc. Other noted marks are trademarks of their respective companies. Holocom products protected by US Pats. D619,097; D632,763; D580,871; 7,608,780; 7,661,375; 7,183,488; 7,115,814; 7,053,303; 7,049,517; 6,838,616; 5,831,211 and pats pending. Made in the U.S.A. Copyright © 2012 Holocom, Inc. All rights reserved.